

## ► Spring Plunger (PSP-P)

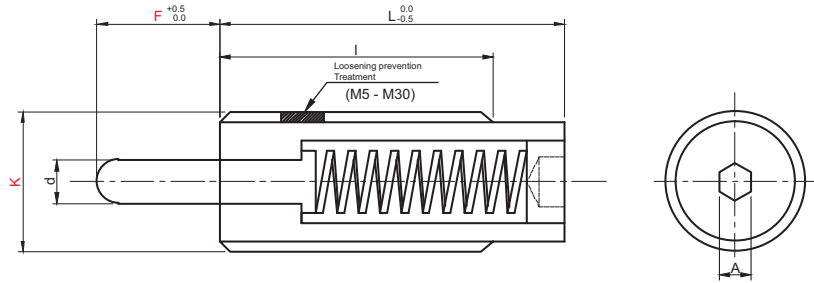

**Material :-** En8d  
**Hardness :-** 32-38 HRC  
**Surface Treatment :-** Blackodised



Type	d	l	L		A	For light load		K	F
			Light & heavy loads	Extremely heavy loads		min. N(kgf)	max.		
PSP - P	1.1	10 (15)	10	15	0.9	0.44 (0.05)	1.6(0.2)	3	1.5
	1.1	15 (20)	15	20	0.9	0.29 (0.03)	1(0.1)		3
	1.6	15 (24)	15	24	1.3	0.9 (0.1)	4.1(0.4)	4	2
	1.6	24	24	24	1.3	0.7 (0.1)	2.2(0.2)		4
	2	20 (27)	20	27	1.5	1.5 (0.2)	9.8(0.1)	5	3
	2	27 (39)	27	39	1.5	1.6 (0.2)	10.4(1.1)		5
	2.5	25 (30)	25	30	2	3.4 (0.4)	10.4(1.1)	6	3
	2.5	30 (36)	30	36	2	1.9 (0.2)	9.7(1)		5
	2.5	30	39	-	2	1.5 (0.2)	10.9(1.1)		10
	3.1	25 (27)	25	27	2.5	3.5 (0.4)	9.4(1)	8	3
	3.1	27 (30)	27	35	2.5	2.9 (0.3)	9.6(1)		5
	3.1	30	43	-	2.5	3.1 (0.3)	11.2(1.1)		10
	3.8	30	30	35	3	2.8 (0.3)	14.1(1.4)	10	5
	3.8	30	43	53	3	2.9 (0.3)	14.6(1.5)		10
	3.8	30	58	-	3	3.4 (0.4)	17(1.7)		15
	5.5	30 (35)	30	43	4	3.5 (0.4)	17.1(1.7)	12	5
	5.5	35	43	58	4	2.5 (0.3)	21.1(2.2)		10
	5.5	35	51	78	4	2.3 (0.2)	19.4(2)		15
	5.5	35	78	-	4	4.1 (0.4)	22.5(2.3)		20
	8	35	60	60	5	12.1 (1.2)	38(3.9)	16	10
	8	35	60	70	5	9.7 (1)	39.7(4.1)		15
	8	35	85	90	5	8.6 (0.9)	40.1(4.1)		20
	8	35	125	125	5	17 (1.7)	38(3.9)		30
	8	35	125	-	5	5.5 (0.6)	41.2(4.2)		40
	8	35	155	-	5	4.4 (0.5)	48.3(4.9)		50
	8	35	159	-	5	4.1 (0.4)	49.6(5.1)		60
	8	35	185	-	5	3.1 (0.3)	55.7(5.7)		70
	8	35	185	-	5	2.5 (0.3)	51.3(5.2)	80	
	10	45	60	80	6	14.4 (1.5)	79.4(8.1)	20	15
	10	45	72	-	6	13.9 (1.4)	83.4(8.5)		20
10	45	96	-	6	13.6 (1.4)	88.3(9)	30		
10	45	120	-	6	13.4 (1.4)	109.8(11.2)	40		
10	45	60	-	10	27.8 (2.8)	65.9(6.7)	24	7	
10	45	60	84	10	25.5 (2.6)	106.9(10.9)		15	
10	45	75	-	10	15.3 (1.6)	101(10.3)		20	
10	45	100	-	10	19.1 (2)	100(10.2)		30	
10	45	124	-	10	17.1 (1.7)	98.1(10)		40	
14	45	66	-	14	9.3 (1)	104.4(10.7)		30	15
14	45	78	-	14	55.2 (5.6)	156.9(16)			20
14	45	100	-	14	28.4 (2.9)	128.3(13.1)			30
14	45	123	-	14	14.7 (1.5)	109.2(11.1)	40		

**Order Type :-** Code X K X F | **Example :-** PSP-P X 6 X 10